



29 et 31, Rue de la Perrière

PLAN DE DIVISION

-  Application Cadatrale
-  Unité foncière
-  Espace Vert imposé
-  Accès
-  Arbre à supprimer

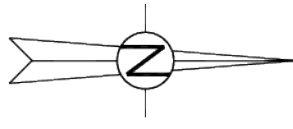
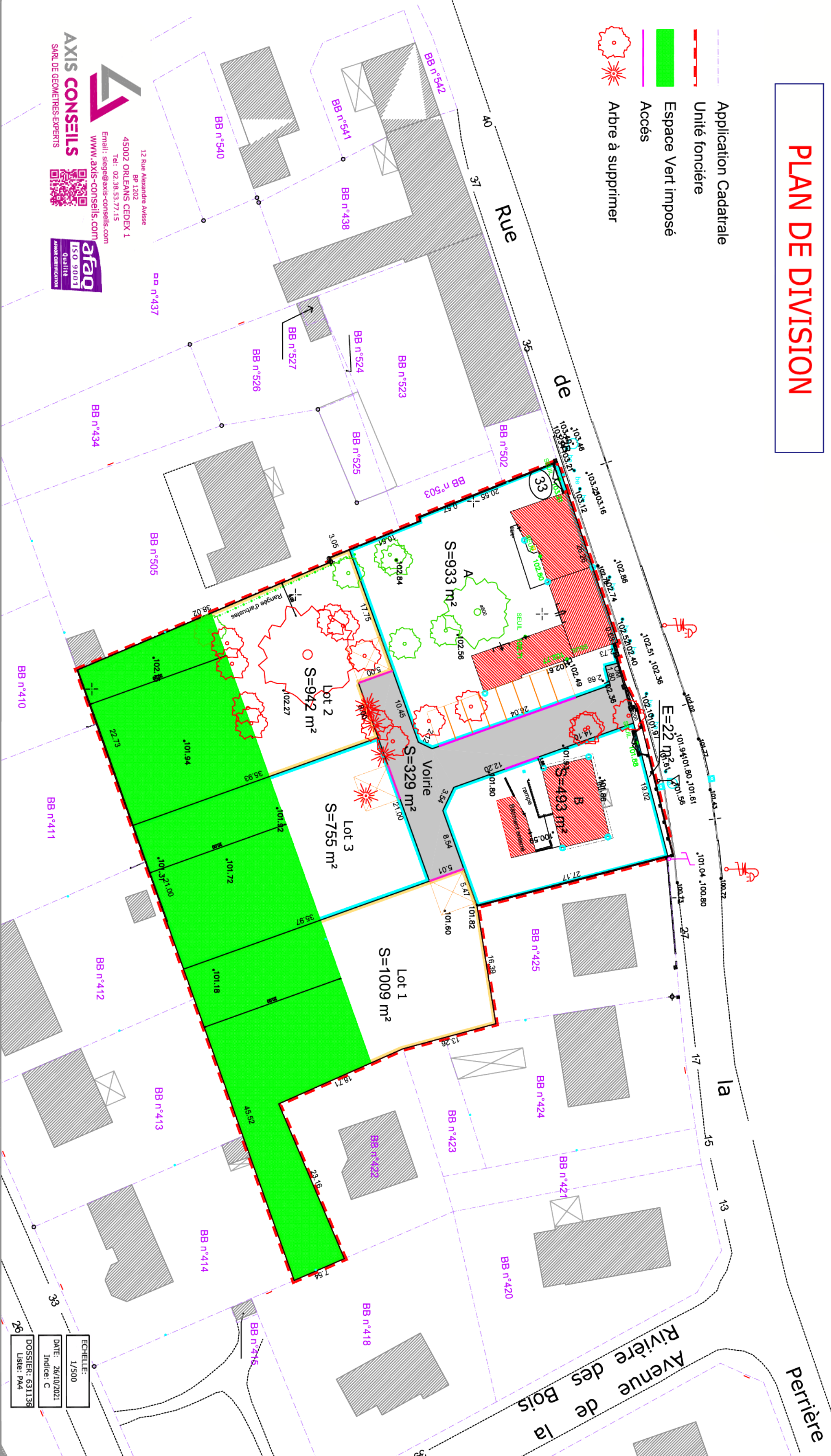

AXIS CONSEILS
SARL DE GEOMETRES-EXPERTS

12 Rue Alexandre Avise
BP 1202
45002 ORLEANS CEDEX 1
Tel: 02.38.53.77.15
Email: siege@axis-conseils.com
www.axis-conseils.com

afaq
ISO 9001
QUALITE
AVANCEE CERTIFIEE

ECHELLE: 1/500
DATE: 26/10/2021
Indice: C
DOSSIER: 631136
Liste: PA4